

SITE GENERAL NOTES

1. WORK UNDER THIS CONTRACT INCLUDES ALL DESIGNATED CONCRETE WALKS, PADS, CURBS & ASPHALT PAVING WITHIN THE CONTRACT EXTENTS. PROVIDE ALL SITE WORK INDICATED INCLUDING TOPSOIL, IRRIGATION, LANDSCAPING, SEEDING, ETC. TO PROVIDE A COMPLETE FINISHED SITE. SEE IRRIGATION, LANDSCAPING, CIVIL, MECHANICAL & ELECTRICAL FOR EXTENT OF WORK UNDER THOSE SUBCONTRACTORS.
2. SEE CIVIL PLANS FOR CONCRETE CURBS, WALKS AND PAVEMENT INFORMATION.
3. DIMENSIONS ARE TYPICALLY TO FACE OF CONCRETE FOUNDATION, EDGE OF WALK OR PAVING SITE OF CURB.
4. SEE CIVIL FOR THE EXISTING SITE SURVEY.
5. LOCATE SIDEWALK CONTROL OR EXPANSION JOINTS AS SHOWN IN WALKS & SLABS. JOINTS TO BE EQUALLY SPACED AS SHOWN AT INTERSECTING POINTS. IF JOINTS ARE NOT SPECIFICALLY DIMENSIONED, ALIGN WITH BUILDING COLUMNS AND PIERS. BUILDING OFFSETS, CENTERED ON OPENINGS FOR ALIGN WITH OTHER BUILDING ELEMENTS SHOWN. SEE DETAIL 1/A1.05 FOR TYPICAL CONCRETE JOINTS.
6. EXPANSION JOINTS ARE REQUIRED WHEREVER CONCRETE WALKS ABUT SITE OR BUILDING WALLS - SEE DETAIL 1/A1.05 FOR TYPICAL JOINTS.
7. MOW STRIPS ARE REQUIRED WHEREVER TURF AREAS ABUT SITE OR BUILDING WALLS - SEE DETAIL 2/A1.05 AND LANDSCAPE DRAWINGS.
8. PROVIDE HANDRAILS ON BOTH SIDES OF ALL RAMPS & STAIRS INDICATED ON PLANS UNLESS NOTED OTHERWISE. HANDRAILS TO BE INSTALLED AS SHOWN ON DETAILS IN SECTIONS AND ELEVATIONS.
9. SEE CIVIL, MECHANICAL AND ELECTRICAL DRAWINGS FOR UTILITIES, MANHOLES, VAULTS AND OTHER WORK RELATED TO THOSE DISCIPLINES.
10. PATCH AND REPAIR ALL EXISTING CONCRETE CURBS, WALKS, ASPHALT PAVING, UTILITIES, ETC., DAMAGED OR OTHERWISE AFFECTED BY THIS WORK.
11. VERIFY DIMENSIONS PRIOR TO CONSTRUCTION AND NOTIFY THE ARCHITECT OF ANY DISCREPANCIES PRIOR TO PROCEEDING WITH CONSTRUCTION.
12. PROVIDE PIPE SLEEVES UNDER SIDEWALKS AND ASPHALT PAVING - COORDINATE DETAIL AND LOCATIONS WITH CIVIL, LANDSCAPE AND ELECTRICAL.
13. COORDINATE WITH THE VARIOUS UTILITY COMPANIES FOR THEIR SERVICE INSTALLATION.
14. SEE OVERALL PLAN ALONG WITH CIVIL, LANDSCAPE AND ELECTRICAL FOR ADDITIONAL SCOPE AT SOUTH-WEST FOR DIGITAL READER BOARD.
15. SEE CIVIL FOR ALL ROAD SIGNS, PAVEMENT STRIPING AND ACCESSIBLE PARKING STALLS, DIMENSIONS AND NOTES ON THIS SITE PLAN ARE FOR INFORMATION ONLY.

CODED NOTES - SITE PLAN

- 1 FOR ADDITIONAL WORK ON WELLESLEY - SEE CIVIL
- 2 CONC WALKS AND DRIVE APPROACHES, CTRL JOINTS AS SHOWN - SEE CIVIL FOR LAYOUT AND DETAILS
- 3 SOFTBALL OR BASEBALL FIELD AND BACKSTOP - SEE LANDSCAPE
- 4 SOCCER FIELD - SEE LANDSCAPE
- 5 GRASS RUNNING TRACK - SEE LANDSCAPE
- 6 FOOTBALL FIELD - SEE LANDSCAPE
- 7 DOUBLE LANE LONG/TRIPLE JUMP PIT AND GRASS RUNNING LANES - SEE LANDSCAPE
- 8 SHOT PUT PRACTICE PAD - SEE LANDSCAPE
- 9 SITE LIGHT - SEE ELEC
- 10 PARKING STRIPING & CROSSWALKS - SEE CIVIL
- 11 BUS LOADING ZONE STRIPING - SEE CIVIL
- 12 VAN ACCESSIBLE STALL - SEE CIVIL
- 13 ACCESSIBLE STALL - SEE CIVIL
- 14 PARENT DROP-OFF STRIPING - SEE CIVIL
- 15 CONC WALKS AND DRIVE APPROACHES, CTRL JOINTS AS SHOWN - SEE CIVIL FOR LAYOUT AND DETAILS
- 16 BIKE RACK AREA - SEE LANDSCAPE
- 17 FIRE HYDRANT - SEE CIVIL
- 18 4'-0" CL FENCE, TYP ALONG BUS LANE - SEE LANDSCAPE
- 19 6'-0" FENCE, TYP AT COURTYARD - SEE LANDSCAPE
- 20 4'-0" EXIT GATE - SEE DETAIL 5/A1.04
- 21 CONC & ROCK WALLS - SEE LANDSCAPE
- 22 FLAGPOLE - SEE LANDSCAPE AND DETAIL 3/A1.04
- 23 CARD READER ON 6" ROUND BOLLARD PER HARDWARE SPEC - RECESS BOLLARD MOUNT BELOW GROUND PER DETAIL 22/A1.04

PARKING CALCULATIONS
 PARKING REQUIRED:
 MINIMUM: 1 PER TEACHING STATION (49)
 MAXIMUM: 2.5 STALLS PER TEACHING STATION: (49) x 2.5 = 123
 PARKING PROVIDED: 123 STALLS
 ACCESSIBLE STALLS REQUIRED: IBC TABLE 1106.1 101-150 STALLS: 5 MINIMUM
 ACCESSIBLE STALLS PROVIDED: 6 STALLS, (2 VAN ACCESSIBLE)
 NOTE: NORTHEAST PARKING, (8 STALLS + 1 VAN ACCESSIBLE), FOR PLAYFIELDS NOT INCLUDED IN CALCULATION

FIRE APPARATUS LANE CALCULATION
 TOTAL BUILDING PERIMETER: 2101.5'
 25% OF TOTAL PERIMETER: 525.4'
 PROVIDED: 530.25'

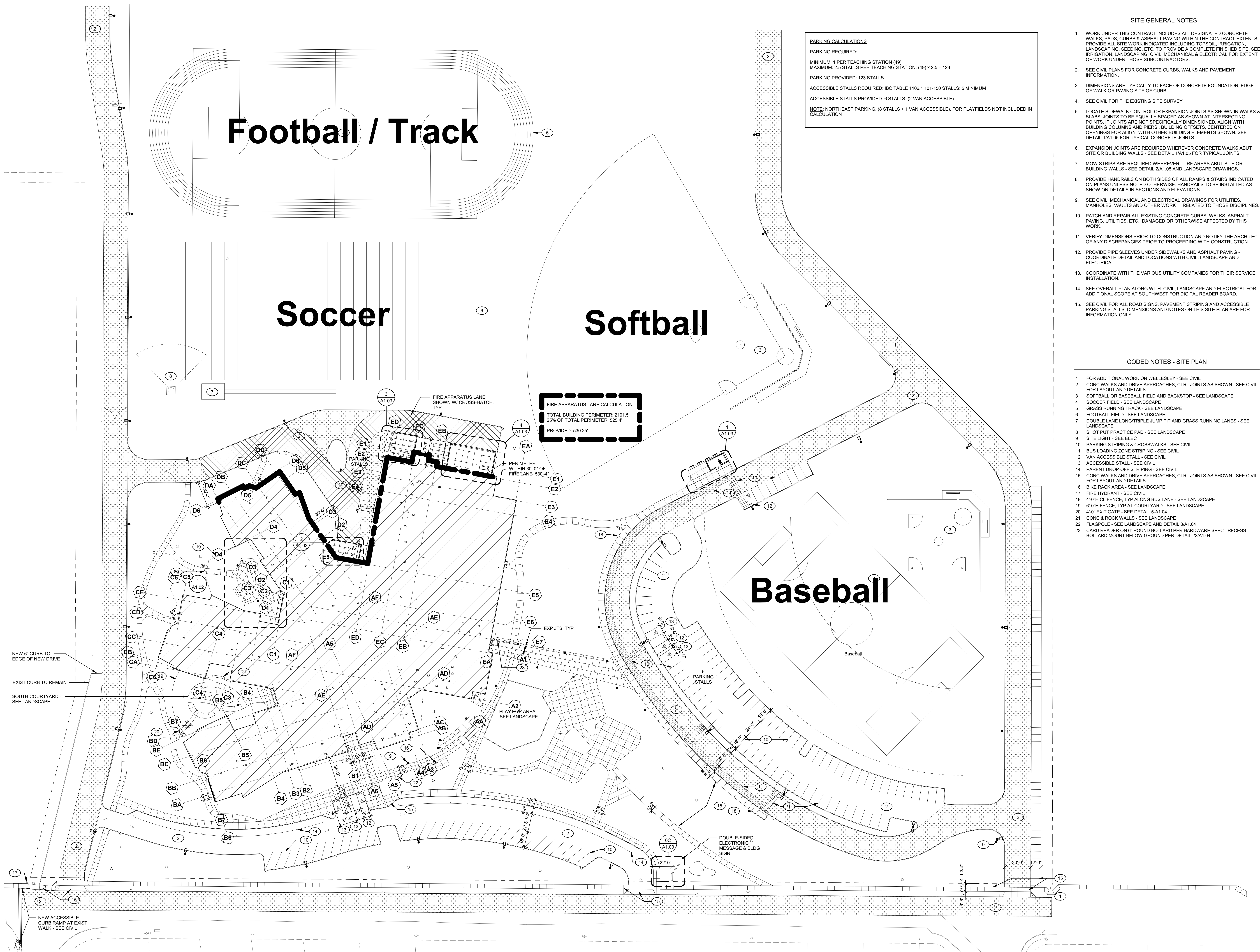

OVERALL ARCHITECTURAL SITE PLAN
 Scale: 1" = 40'-0"

CONFORMED SET

7714 REGISTERED ARCHITECT
 JAMES H. HUBBARD
 DANIEL A. HARRINGTON
 STATE OF WASHINGTON

8226 REGISTERED ARCHITECT
 MELISSA A. HANCOCK
 STATE OF WASHINGTON

SPOKANE PUBLIC SCHOOL DISTRICT NO. 81
NEW NORTHWEST MIDDLE SCHOOL
 5020 W WELLESLEY, SPOKANE, WA 99205

NAC
 ARCHITECTURE
 nacarchitecture.com
 1203 WEST RIVERSIDE AVE
 SPOKANE, WA 99201
 P.509.838.8240

NAC NO 111-19117
 DRAWN
 CHECKED RSW
 DATE 4-19-2021

OVERALL ARCHITECTURAL SITE PLAN

A1.01